

Probe / Receptacle Assembling, Extraction Only Tool

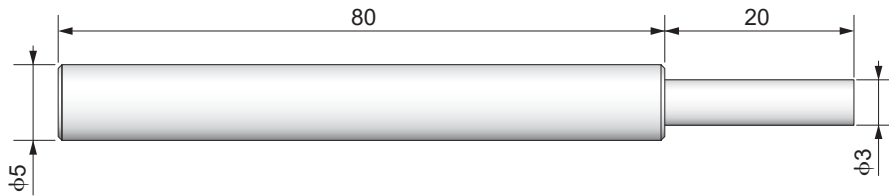

Probe Insertion Tool



Material:POM

Probe Extraction Tool

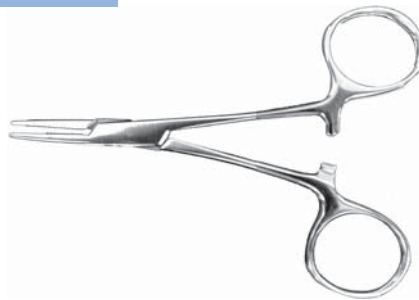

Material:SUS

Receptacle Insertion Tool

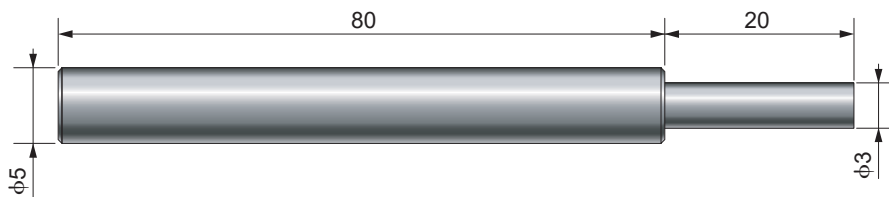

Material:SUS

Receptacle Extraction Tool

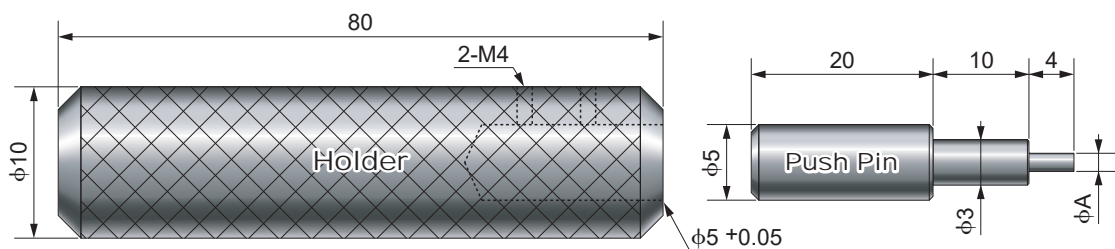

Material:SUS

Material:SK(Ni)

Push Pin Lineup

Series	026	031	040	050	058	068	100	137
φA	φ0.35	φ0.38	φ0.57	φ0.70	φ0.74	φ0.88	φ1.35	φ1.75

[How to use]

Please insert the push pin into the holder, fix it with screws and use.

We have stock push pin for series "026" ~ "137".

● All specifications are subject to change without notice.

TAISEI Co.,Ltd. Head Office Sales Dept.

Address : 6972 Shimo-Yoshida, Chichibu-shi, Saitama-ken,
369-1593, JAPAN.

Phone : +81-494-77-1211 / FAX : +81-494-77-1415

Sales Office **MKT TAISEI Co.,Ltd.**

Address : 3-10-8, Nohagi 1st Bldg, Minami-Ikebukuro, Toshima-ku, Tokyo, 171-0022, Japan.
Phone : +81-3-3982-0029 / FAX : +81-3-3986-1537

Web Site : <http://www.mkt-taisei.co.jp/>

e-original_tool-01